

WOODLAWN HISTORIC SITE
AND
CULTURAL CENTER





National Trust Historic Sites

Trust Sites by the Numbers

The National Trust leads by example across our nationwide portfolio of sites:

27

Historic Sites

308

Roofed Structures

4,190

Acres

60k

Objects

1 Million

Visitors Annually



A Vision for Trust Sites

National Trust Sites are places of national significance or impact where a variety of ownership, stewardship, business, use, and engagement practices flourish to advance the National Trust mission and **model the many options for preservation.**



Shared Use

- A prototype for the re-imagination of historic sites.
- Provides expansive and sustainable public benefit.
- Dynamic interpretation of a place's history can be creatively integrated with compatible nonprofit and commercial uses in ways that are resonant with the property's history.
- Preservation and interpretation are infused into all operations to engage broad audiences with diverse stories told through a variety of methods and experiences.

Cooper Molera Adobe, one of the most iconic properties in Monterey, is coming back to life.

David Schmalz Jun 28, 2018 0

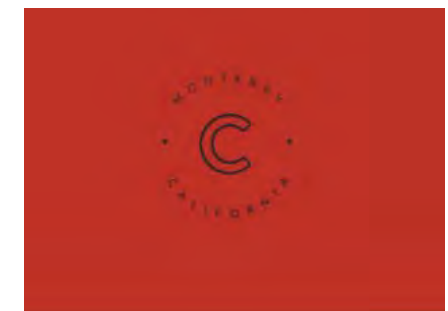

CELLA
RESTAURANT & BAR

Shared Use at Cooper-Molera





HILLTOP FARM

Children's garden, demonstration, food production and volunteer space since 2011
(1 Acre)

DOGUE FARM

Food production since 2016, more than 200,000 servings to date.
(3 Acres)

VETERAN FARM INCUBATOR

"Woodbox Farm" since 2018
(1 Acre)



WOODLAWN HISTORIC SITE
AND CULTURAL CENTER



Arcadia Farm grows more than 35 varieties of fruits and vegetables using sustainable practices that build soil fertility and protect and support human health, wildlife, pollinators, and the watershed. These include but are not limited to:

- Cover crop
- Crop rotation
- Encouraging biodiversity
 - Drip irrigation
- Organic management
 - Composting
 - Hand-weeding



EXISTING AERIAL SITE



MOUNT VERNON CULTURAL CORRIDOR

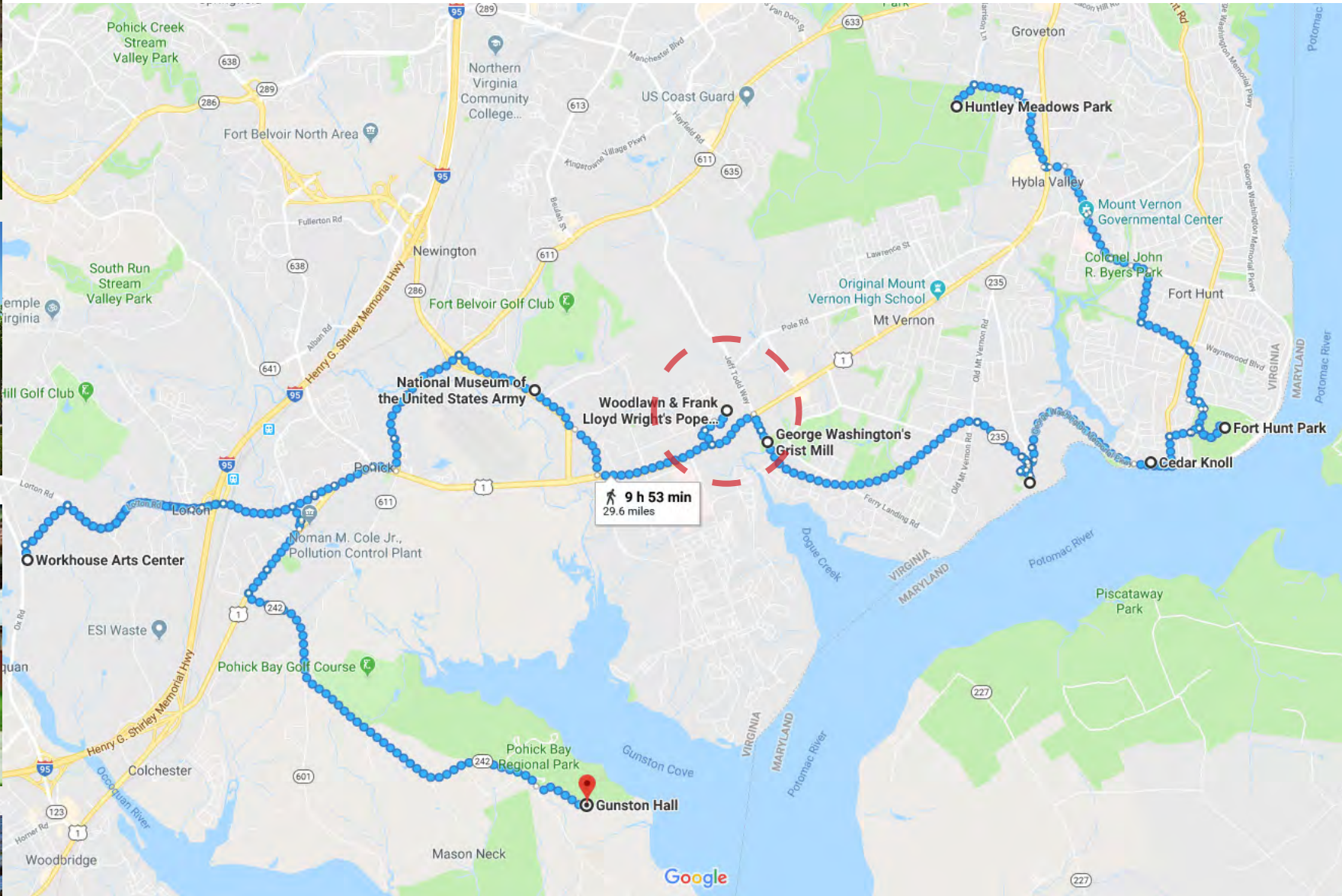





AREA 1 EXISTING RESOURCES



WOODLAWN MANSION



"FRONT" LAWN FROM ABOVE

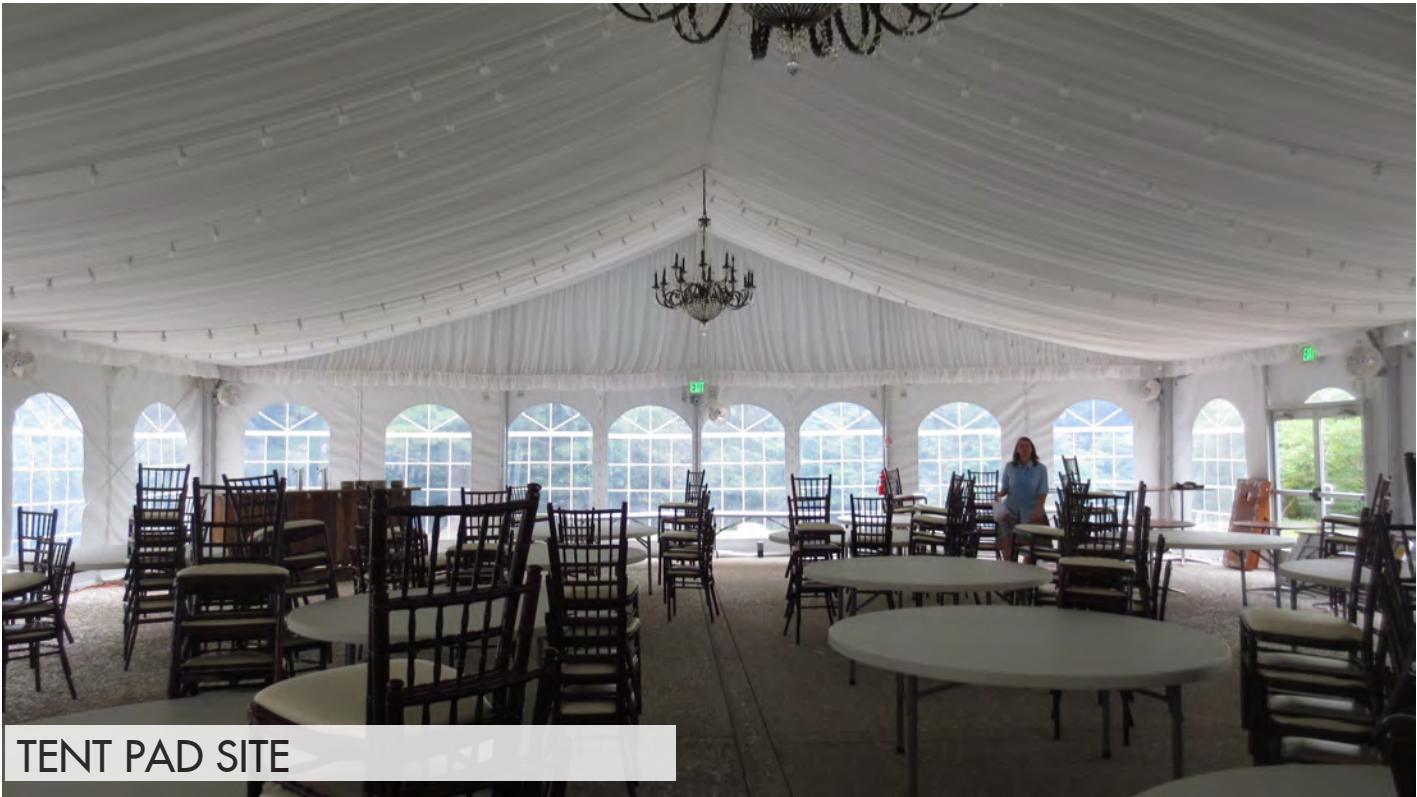

TENT PAD SITE



BOXWOOD GARDEN

AREA 1 INSPIRATION



natural wooded amphitheater



special events



special events



local natural materials



AREA 2: RESTAURANT CORE

0' 25' 50' 100'

EXISTING

PROPOSED

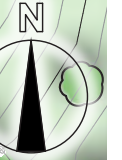

MOVABLE BAR

DROP-OFF W/ PATH

OUTDOOR KITCHEN

- Refrigeration & prep
- Teaching Kitchen

OUTDOOR DINING

- Coverable for shade or inclement weather

ARCADIA FARM

- Raised beds

ADD'L STAFF PARKING

POTTING SHED

- Storage & Restrooms

GAZEBO

- Relocated
- Restaurant greeter

HISTORIC GARDENS

- Re-established by NTHP

GARDEN SHED

CEDAR ALLEE

GARAGE & MAINTENANCE SHED

- Lodging

WOODLAWN HISTORIC SITE
AND CULTURAL CENTER

AREA 2 EXISTING RESOURCES



HILLTOP FARM



GROUND HOG GARDEN



GARDEN SHED



GAZEBO

AREA 2 INSPIRATION



semi-covered outdoor dining



covered outdoor cooking pit



outdoor dining among raised beds

AREA 2 INSPIRATION

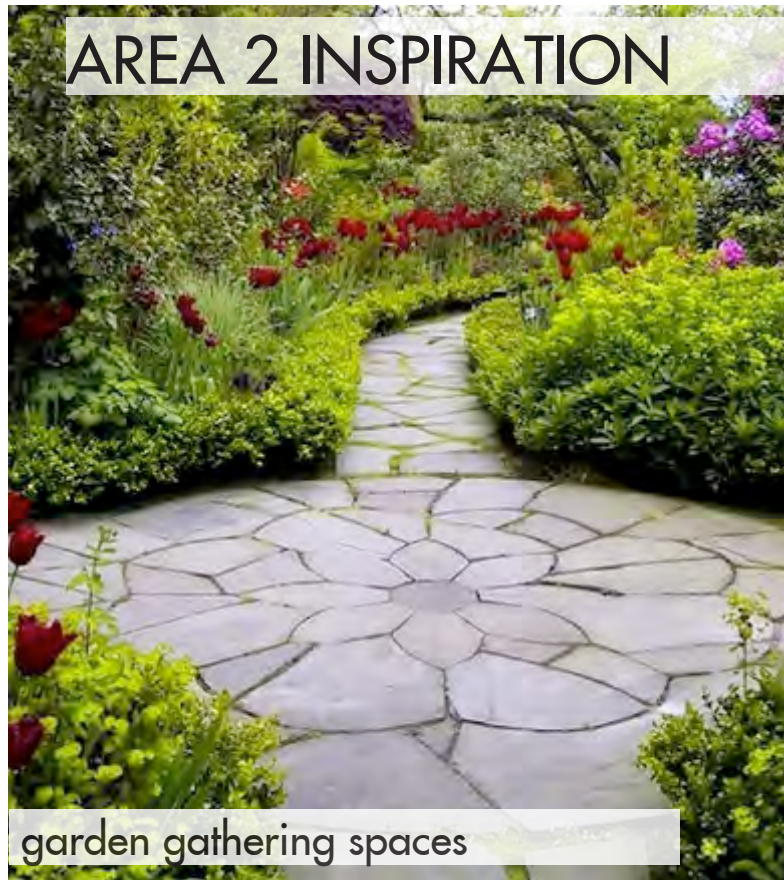

garden gathering spaces



gazebo axis



raised garden beds



covered garden dining area

AREA 2: RESTAURANT CORE - VIEW 1 COVERED



AREA 2: RESTAURANT CORE - VIEW 1 UNCOVERED



AREA 2: RESTAURANT CORE - VIEW 2 COVERED



AREA 2: RESTAURANT CORE - VIEW 2 UNCOVERED





AREA 3: SPECIAL EVENT & PROGRAM LODGING CORE

EXISTING

PROPOSED



PARKING

PINE ALLÉE

· *Re-established*

GARAGE & MAINTENANCE SHED

· *lower level converted to lodging*
· *2nd Floor existing lodging*

GAZEBO

GRANDVIEW

· *Special Event & Program Lodging*

WOODLAWN HISTORIC SITE
AND CULTURAL CENTER

AREA 3 EXISTING RESOURCES



SERVICE ROAD ENTRANCE



GARAGE & MAINTENANCE SHED



GRANDVIEW



GRANDVIEW



AREA 4: SHARPE BARN COMPLEX

EXISTING

PROPOSED



RIGHT-IN ACCESS FROM ROUTE 1

HISTORIC ROUTE 1

OTIS MASON HOUSE
· *Retail and housing*

CORN CRIB
· *Gateway to Sharpe Barn Complex*

BANK BARN
· *Farmers' market upstairs*
· *Flexible retail space downstairs*

ROUTE 1 TUNNEL TO FIELDS

ROUTE 1

STABLES
· *Wine/cider tasting*

DAIRY
· *Florist/retail downstairs*
· *Arcadia offices upstairs*

PARKING

FARMERS' MARKET

EDIBLE LANDSCAPING

NANO-BREWERY + CAFE
· *Brewery upper level*
· *Cafe courtyard level*

COURTYARD
· *Pergola, fire pit, water feature*

WOODLAWN HISTORIC SITE
AND CULTURAL CENTER

AREA 4 EXISTING RESOURCES



CORN CRIB



OTIS MASON HOUSE

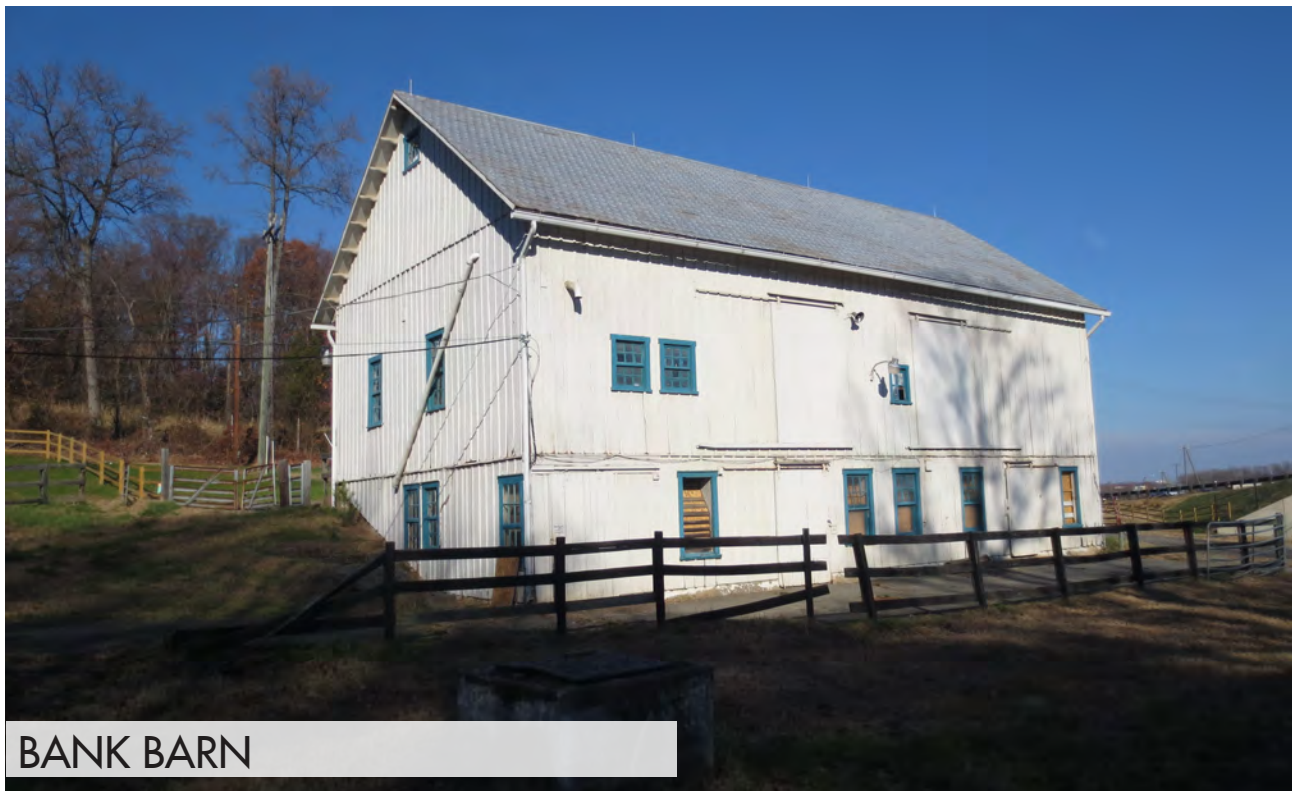

BANK BARN



DAIRY



STABLES

AREA 4 INSPIRATION



refurbished stables for wine tasting



light, airy nano-brewery



cantilevered pergola



refurbished barn with retail w/ focus on Made in FFX

AREA 4: SHARPE BARN COMPLEX



AREA 4: SHARPE BARN COMPLEX







AREA 5 EXISTING RESOURCES

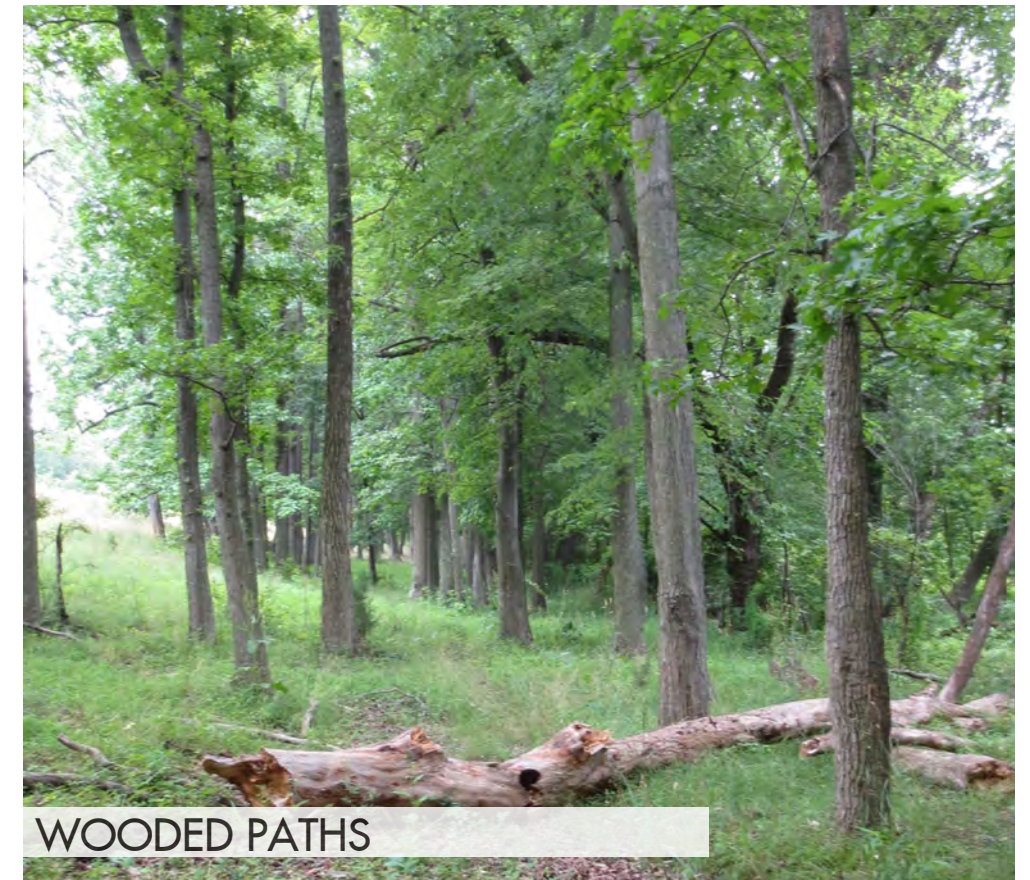

AREA 5 INSPIRATION

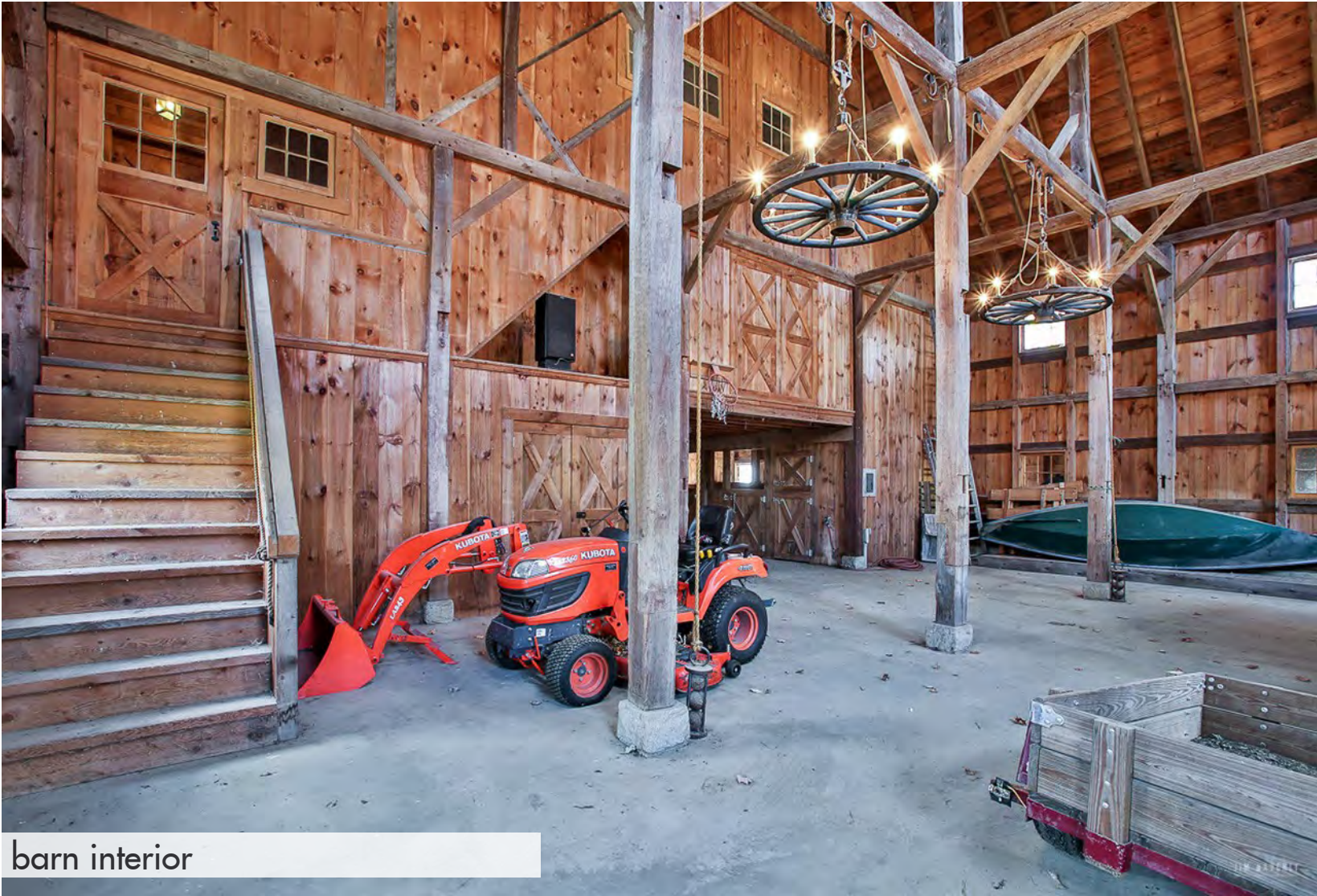

barn interior



intern tents



barn exterior

AREA 5:
BARN & EVENT SPACE





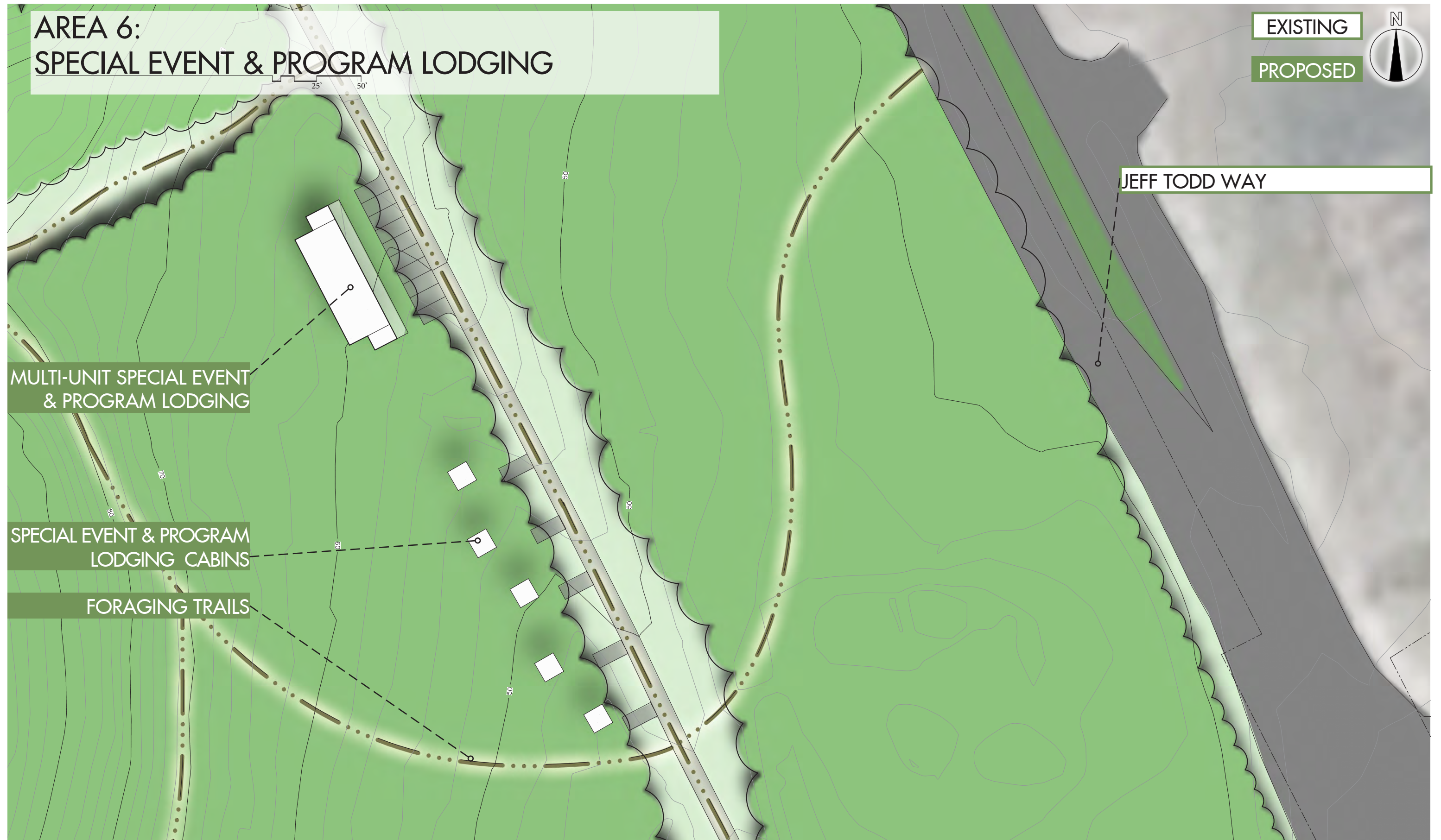

WOODLAWN HISTORIC SITE
AND CULTURAL CENTER

AREA 7: SPECIAL EVENT & PROGRAM LODGING

EXISTING

PROPOSED



FORAGING TRAILS

SPECIAL EVENT & PROGRAM
LODGING CABINS

PAVED PATH

POPE-LEIGHEY HOUSE
Unchanged

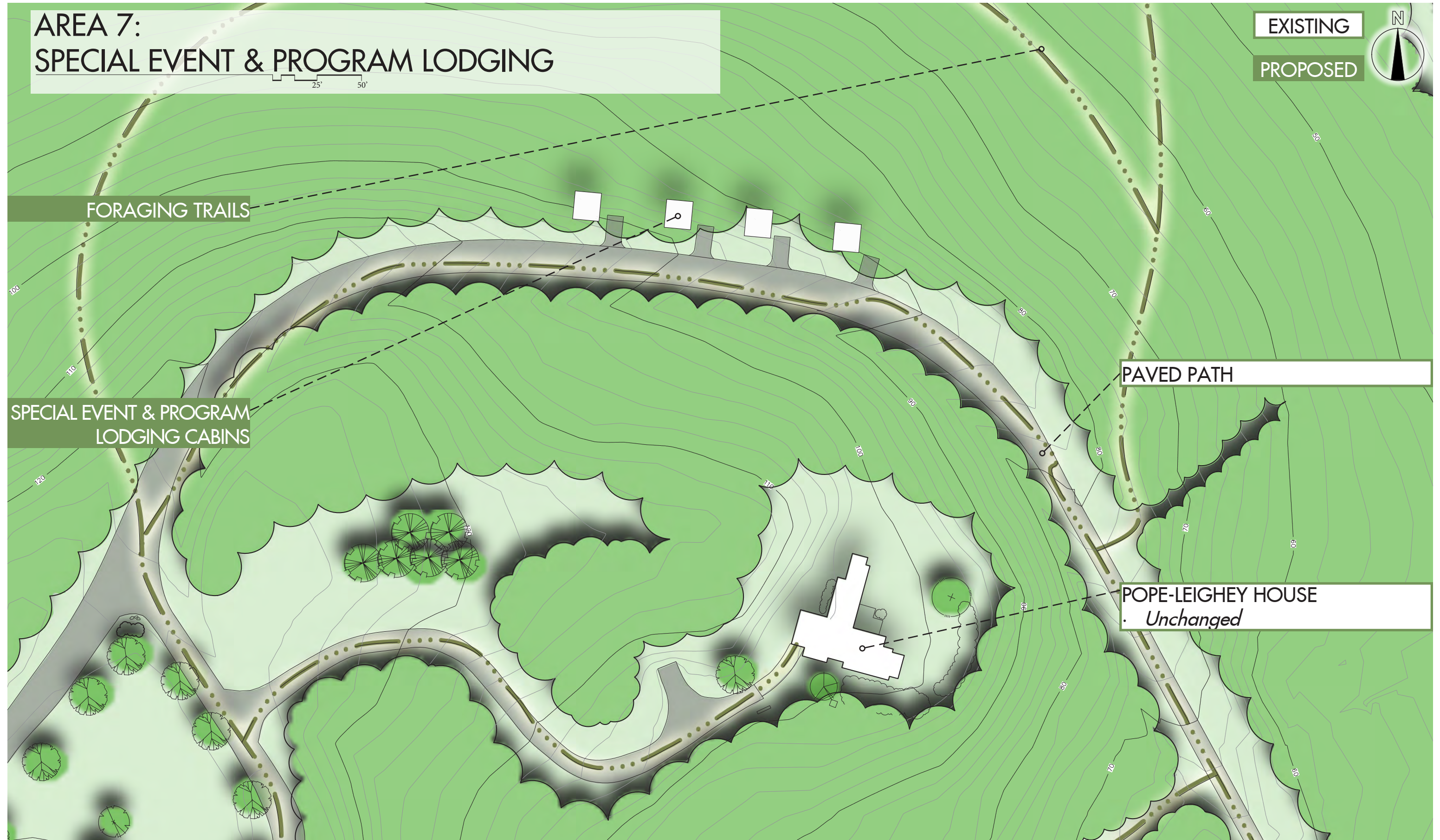

AREA 6 & 7 EXISTING RESOURCES



PAVED TRAIL



POPE-LEIGHEY HOUSE



UTILITY EASEMENT

AREA 6 & 7 INSPIRATION

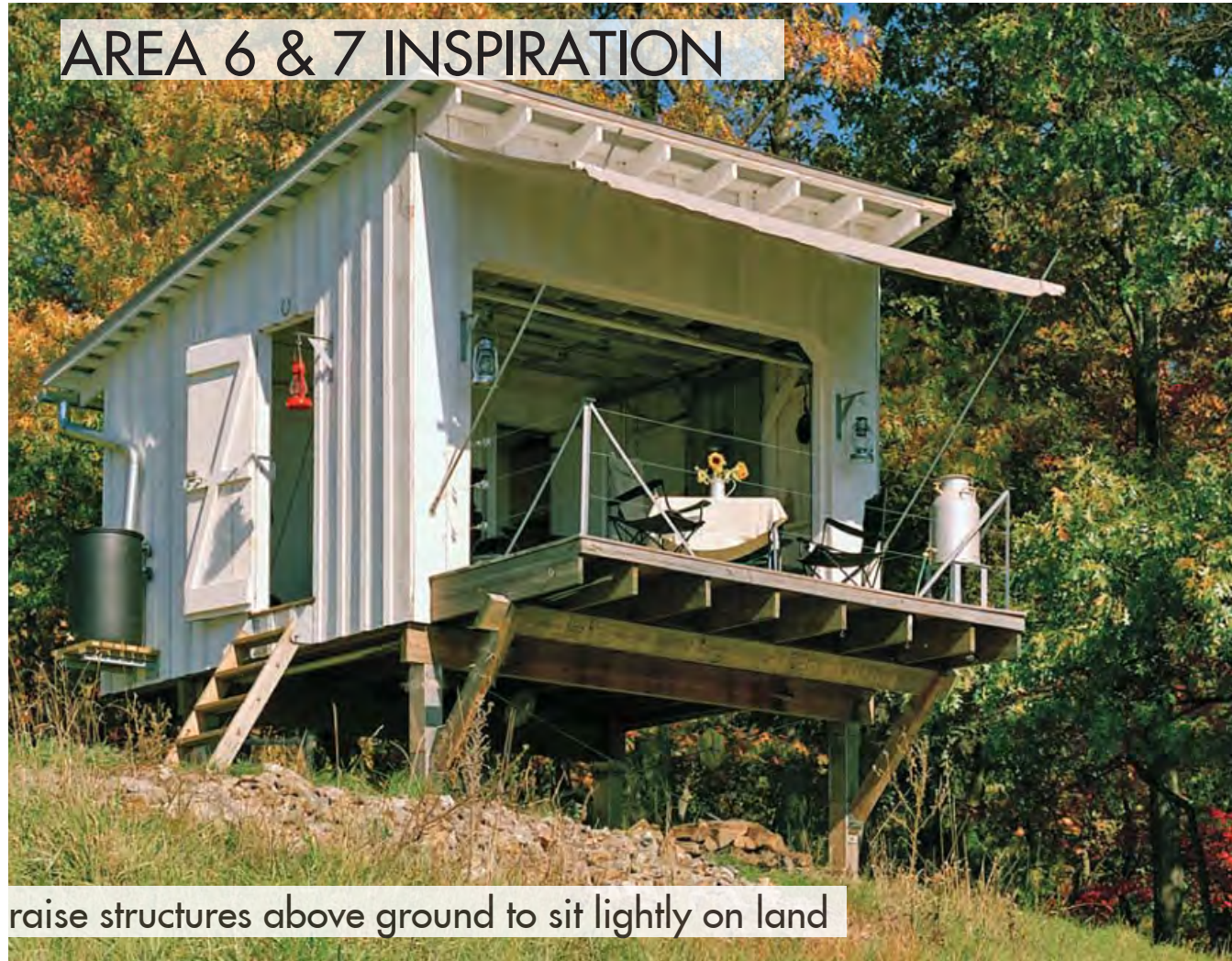

raise structures above ground to sit lightly on land

CABINS



lower apparent height of roof at front face



dark wood facade to recede into landscape

MULTI-UNIT LODGE

SITE-WIDE TRAIL INSPIRATION



trail markers



"smart" guides



wetland trails

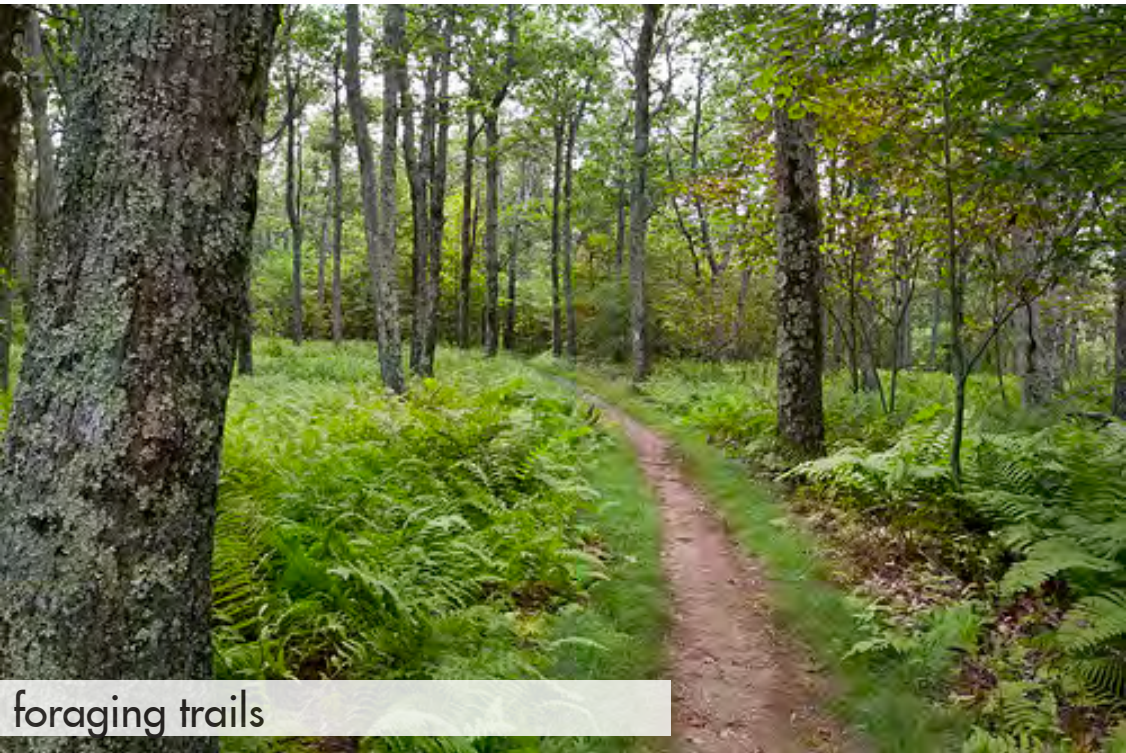

foraging trails



farm trails

QUESTIONS?